

PRODUCT INFORMATION PACKET

Model No: 132MTFC6587

Catalog No: R329A

7.50 HP General Purpose, 3 phase, 1200 RPM, 230/460 V, 132M Frame, TEFC
Cast Iron TEFC Motors





Nameplate Specifications

| | | | |
|------------------------|--------------------|----------------------------|------------------------------------|
| Output HP | 7.50 Hp | Output KW | 5.6 kW |
| Frequency | 60 Hz | Voltage | 230/460 V |
| Current | 21.6/10.8 A | Speed | 1185 rpm |
| Service Factor | 1.15 | Phase | 3 |
| Efficiency | 91 % | Power Factor | 72 |
| Duty | Continuous | Insulation Class | F |
| Design Code | B | KVA Code | H |
| Frame | 132M | Enclosure | Totally Enclosed Fan Cooled |
| Thermal Protection | No | Ambient Temperature | 40 °C |
| Drive End Bearing Size | 6308 | Opp Drive End Bearing Size | 6207 |
| UL | Recognized | CSA | Y |
| CE | Y | IP Code | 55 |

Technical Specifications

| | | | |
|-----------------------|-------------------------------------|-------------------|-------------------------|
| Electrical Type | Squirrel Cage Inverter Rated | Starting Method | Line Or Inverter |
| Poles | 6 | Rotation | Reversible |
| Resistance Main | 0 Ohms | Mounting | Rigid Base |
| Motor Orientation | Horizontal | Drive End Bearing | Ball |
| Opp Drive End Bearing | Ball | Frame Material | Cast Iron |
| Shaft Type | IEC | Overall Length | 19.76 in |
| Shaft Diameter | 1.500 in | Shaft Extension | 3.14 in |
| Assembly/Box Mounting | F3 | | |
| Connection Drawing | 004172.03 | Outline Drawing | SS622237 |

This is an uncontrolled document once printed or downloaded and is subject to change without notice. Date Created:03/11/2020

SS622237

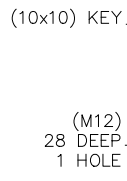
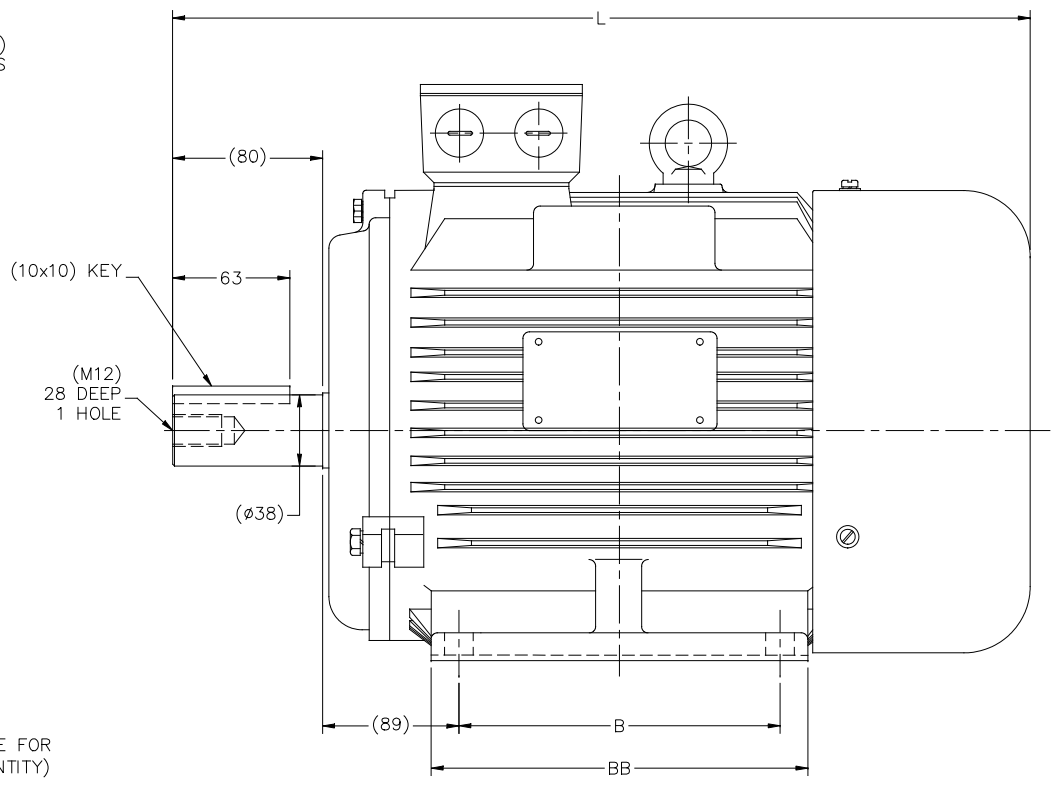
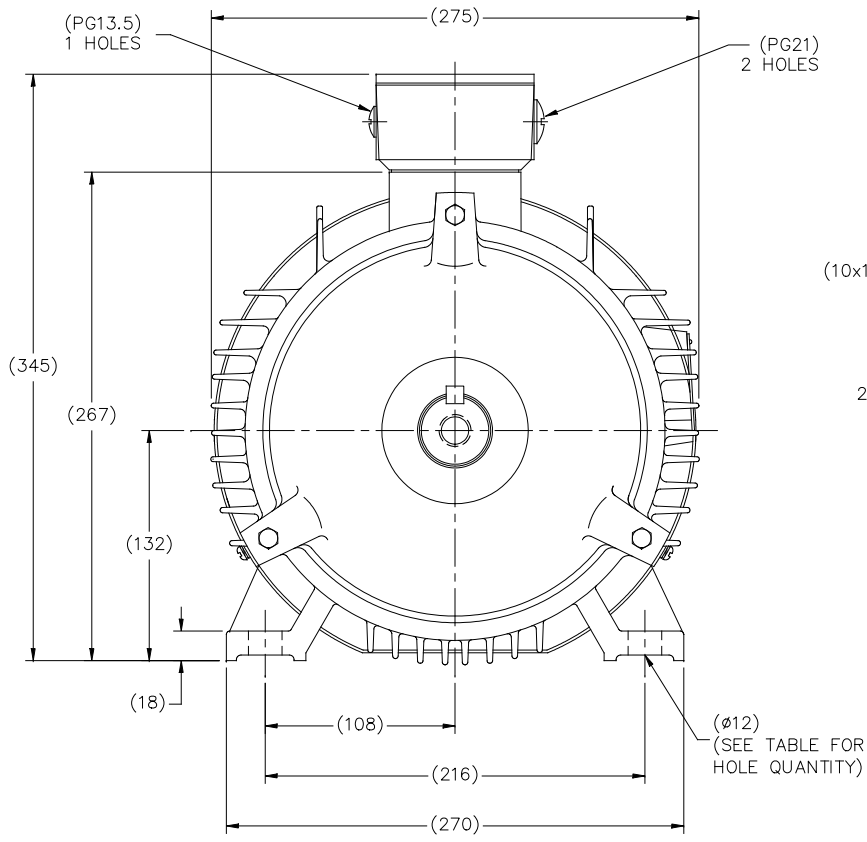

(DRAWING NOT TO SCALE)

(DIMENSIONS ARE IN MILLIMETERS)

| | | | | |
|--------|---------|-----|-----|-----|
| DF132S | 4 | 461 | 140 | 186 |
| DF132M | 4 | 499 | 178 | 224 |
| FRAME | # HOLES | L | B | BB |

| | | TOLERANCES UNLESS SPECIFIED | | REGAL™ Regal Beloit America, Inc. | DRAWN MSG 11-16-2010 | |
|--|---|-----------------------------|----------------|--|----------------------|----------------|
| | | DEC. | METRIC | | CHK | MJS 11-18-2010 |
| 4 | TABLE AND DIMENSIONS UPDATED | NK 07-05-18 | NK .X ±2.5 | TITLE OUTLINE - IEC PREMIUM DF132-R FRAME | APPD | SB 11-18-2010 |
| 3 | (4) FOOT HOLES WERE (6) ECO-0130304 | WGJ 10-2-17 | EMH .XX ±.76 | | SCALE | NONE |
| 2 | REV CAT# FROM BLOCK-FOR CAT# SEE SS622237-CAT | MOL 11-29-12 | .XXX ±.127 | | REF | |
| 1 | REV PG13.5 HOLES WERE 2 QTY | MOL 09-24-12 | .XXX ±.0127 | | FMF | HEBEL |
| NO. | REVISION | BY & DATE | CHK ANG ±7'30" | | FINISH | PREV |
| THIS DRAWING IN DESIGN AND DETAIL IS OUR PROPERTY AND MUST NOT BE USED EXCEPT IN CONNECTION WITH OUR WORK ALL RIGHTS OF DESIGN AND INVENTION ARE RESERVED THIS IS AN ELECTRONICALLY GENERATED DOCUMENT - DO NOT SCALE THIS PRINT | | | | RFP 11-18-2010 | CAD FILE SS622237 | SIZE B |
| | | | | DIST | DRAWING NO. SS622237 | PAGE OF |
| | | | | | | REV. H |

WYE - DELTA STARTING USEABLE ON 2,4 AND 6 POLE MOTORS.

LOW VOLTAGE CONNECTION

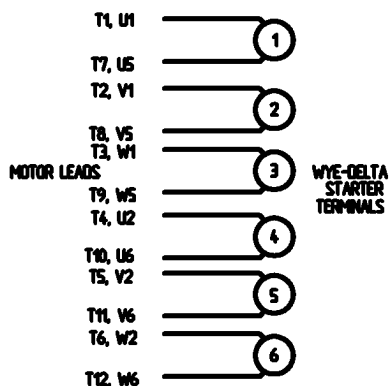

HIGH VOLTAGE CONNECTION

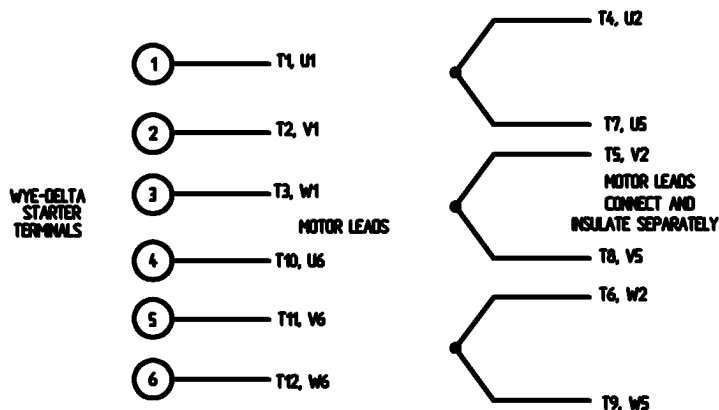

REFER TO THE WYE-DELTA STARTER CONNECTION INSTRUCTIONS FOR PROPER CONNECTION OF POWER LINES TO STARTER.

PART WINDING START USABLE ON 4 & 6 POLE MOTORS
LOW VOLTAGE CONNECTION ONLY

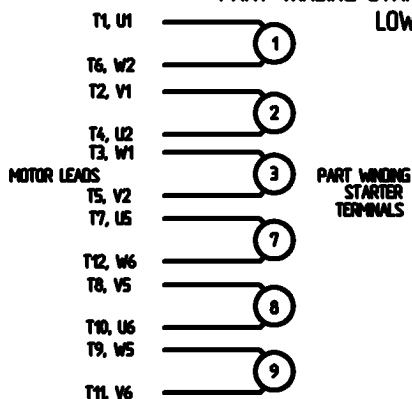

REFER TO THE PART WINDING STARTER INSTRUCTIONS FOR PROPER CONNECTION OF POWER LINES TO STARTER.

REFER TO THE CUTLER - HAMMER OR EQUIV. FOR PROPER SELECTION OF OVERLOAD HEATER COILS.

LINE LEADS

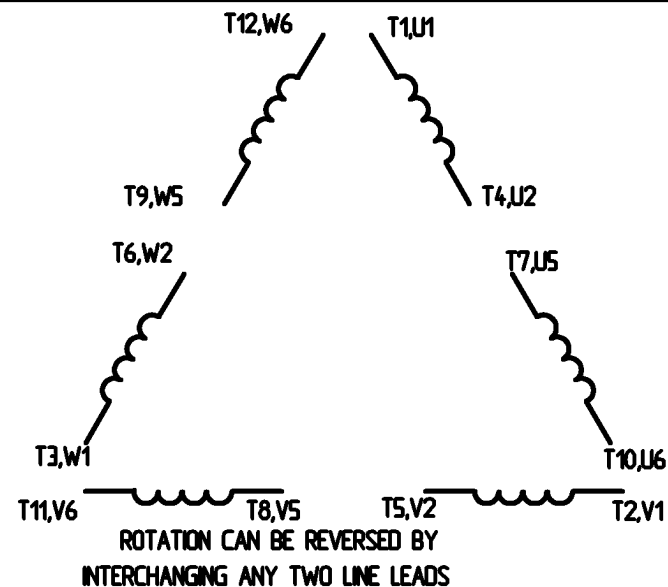

12 LEAD DELTA CONNECTION ACROSS THE LINE START
(FOR Y START DELTA RUN, REMOVE THE JUMPERS)

LOW VOLTAGE
MUST BE REWIRED
AS SHOWN

HIGH VOLTAGE
FACTORY WIRED FOR HIGH
VOLTAGE AS SHOWN

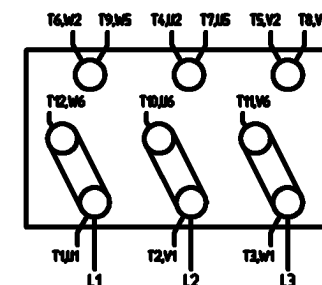
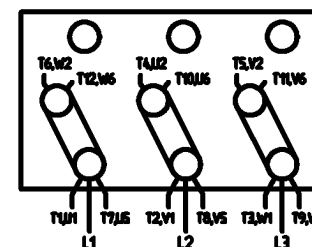

| | | | | | | | | | | | | | | |
|---|----------|-----------|-----|-----------------------------|---------|---|----------|-------------|------|---|-------------|-----------|------|--|
| | | | | TOLERANCES UNLESS SPECIFIED | | <p>ELECTRIC MOTORS GEARMOTORS AND DRIVES</p> | DRAWN | CW 08/28/02 | | | | | | |
| | | | | DEC. | INCHES | | CHK | | | | | | | |
| | | | | X | + .1 | | APPO | | | | | | | |
| | | | | XX | + .01 | | SCALE | 1:1 | | | | | | |
| | | | | XXX | + .005 | | REF | | | | | | | |
| | | | | XXXX | + .0005 | FINISH | | | | | | | | |
| NO. | REVISION | BY & DATE | CHK | ANG | + 1/2° | RFP | CAD FILE | 00417203 | SIZE | A | DRAWING NO. | 004172-03 | REV. | |
| THIS DRAWING IN DESIGN AND DETAIL IS OUR PROPERTY AND MUST NOT BE USED EXCEPT IN CONNECTION WITH OUR WORK. ALL RIGHTS OF DESIGN AND INVENTION ARE RESERVED. THIS IS AN ELECTRONICALLY GENERATED DOCUMENT - DO NOT SCALE THIS PRINT. | | | | DST | | | | | | | | | | |

```
ERROR: syntaxerror  
OFFENDING COMMAND: --nostringval--
```

```
STACK:
```

```
/CB  
-dictionary-  
/Pscript_WinNT_Compact  
-dictionary-
```



P.O. BOX 8003
WAUSAU, WI 54401-8003
PH. 715-675-3311

DATA VOLTS: 460

CERTIFICATION DATA SHEET

CUSTOMER: _____
 ORDER #: 004172.03
 CONN. DIAGRAM: SS622237
 WINDING: T10706011 NONE 3
 SPEED: _____

CUSTOMER P.O. #: _____
 REFERENCE MODEL #: 132MTFC6587
 CAT #: #VALUE!
 CUSTOMER PART #: _____
 MOUNTING: F3

TYPICAL MOTOR PERFORMANCE DATA

| | | | | | | | | | |
|-----|-------------|-----------------|----------------|------------------|-----------------|-------------|-----------|-------------------|-------|
| HP | KW | SYNC RPM | FL RPM | FRAME | ENCLOSURE | TYPE | KVA CODE | DESIGN | |
| 7.5 | 5.6 | 1200 | 1185 | 132M | TEFC | TFC | H | N | |
| PH | HZ | VOLTS | AMPS | START TYPE | DUTY | INSL | S.F. | AMB | ELEV. |
| 3 | 60/50 | 230/460#200/400 | 21/10.5&19/9.5 | LINE OR INVERTER | CONT | F | 1.15 | 40 | 3300 |
| | F.L. EFF | 91.0 | 3/4 LD EFF | 91.0 | 1/2 LD EFF | 89.5 | GTD EFF | ELECT. TYPE | |
| | F.L. PF | 72.0 | 3/4 LD PF | 65.0 | 1/2 LD PF | 52.0 | 90.2 | SQ CAGE INV RATED | |
| | F.L. TORQUE | LR AMPS @ 460 V | | L.R. TORQUE | | B.D. TORQUE | | F.L. RISE (° C) | |
| | 33.2 LB-FT | 74.5 | | 65.0 LB-FT | | 108 LB-FT | | 325% | |
| | @ 3 FT. | POWER | ROTOR WK² | MAX. LOAD WK² | SAFE STALL TIME | STARTS/HOUR | MOTOR WGT | | |
| | 60 DBA | 69 DBA | 0.00 LB-FT² | 0 LB-FT² | 0 SEC. | 0 | 240 LB. | | |

*** SUPPLEMENTAL INFORMATION ***

| | | | | | | | | |
|-----------------|------------------|--------------|-------------------|--------------|------------------------|---------------|----------------|---------------|
| DE BRACKET TYPE | ODE BRACKET TYPE | MOUNT TYPE | MOTOR ORIENTATION | SEVERE DUTY | HAZARDOUS LOCATION | DRIP COVER | SCREENS | PAINT |
| STANDARD | STANDARD | RIGID | HORIZONTAL | UM SEVERE | NONE | NO | NONE | BLUE (ENAMEL) |
| BEARINGS | GREASE | SHAFT TYPE | SPECIAL DE | SPECIAL ODE | SHAFT | MATERIAL | FRAME MATERIAL | |
| DE ODE | | | | | | | | |
| BALL BALL | POL YREX EM | STANDARD IEC | NONE | NONE | 1045 HOT ROLLED (C-204 | | CAST IRON | |
| 6308 | 6207 | | | | | | | |
| THERMOSTATS | PROTECTORS | WDG RTD's | BRG RTD's | THERMISTORS | CONTROL | SPACE HEATERS | | |
| NONE | NOT | NONE | NONE | NONE | FALSE | NA | | |
| R1 (ohms/ph) | R2 (ohms/ph) | X1 (ohms/ph) | X2 (ohms/ph) | Xm (ohms/ph) | VIBRATION (in/sec) | FLOAT | | |
| 0 | 0 | 0 | 0 | 0 | 0.080 | ODE | | |

INVERTER TORQUE: CONSTANT 20:1
 INV. HP SPEED RANGE: 1.5 X BASE SPEED

| | |
|----------|------|
| ENCODER: | NONE |
| BRAKE: | NONE |
| FT-LB: | NA |
| VOLTAGE: | NONE |
| HZ: | NONE |

PREPARED BY: EARL BABBITTS
 DATE: 13-07-17

FORM: 3S31 REV. 4 2/27/06

UL: Y-(LEESON UL REC)

